

Please check all room, window and door dimensions to ensure that our proposals meet with your requirements. After checking please sign in the space provided below. Please note that any changes made to the drawings after approvals have been received by our offices will be charged for at the appropriate rate. **No design work will commence until signed approvals have been received.**

Signed _____ Date _____

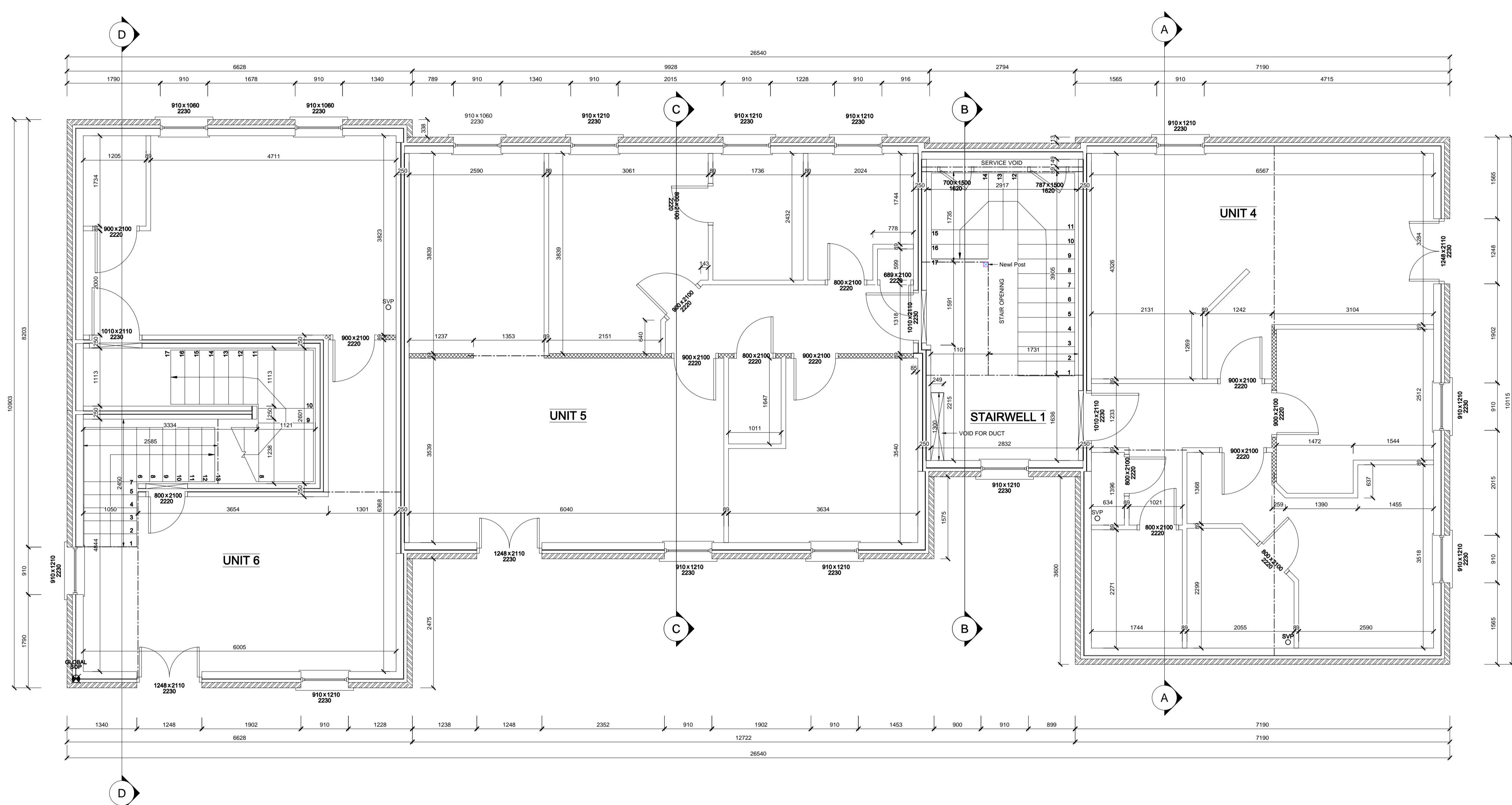

- Notes:**
- Cladding**
102.5 face brick cladding
 - Openings**
All openings are given as structural opening sizes. All openings to have an additional 5mm tolerances to their structural opening size. Windows to have 5mm at each side, top and bottom, doors to have 5mm each side and top.
 - Wall Panels**
Stud walls to be 140x38 for externals and 89x38 for all internals, stud centers and sheathing as per engineers specification (TBC). All stud walls to sit directly on sole plate.
 - Lintels**
Lintels to be a minimum size as specified by engineer.
 - Floors**
Using 240 deep FJI joists with 18mm Sub-decking.
 - Roof**
The roof is to be constructed with trusses and loose rafters @ 600mm C/C Max.

Rev	Description	Date
TimCon Design Ltd Independent Timber Frame Design Consultants		
Unit 4, Sunhill, Fleets Lane, Rylstone, BD23 6NA Tel: 01756 730548 Fax: 01756 730602		
Client	TimCon Design Ltd	
Project	EXAMPLE	
Drawing Title	First Floor Layout	
Status	CONSTRUCTION	
Scale	1:25/50	Date 24.04.07
Job No.	***	Drawn By MC
Drawing No.	102	Revision N/A
THIS DRAWING IS SUBJECT TO COPYRIGHT AND SHOULD THEREFORE NOT BE REPRODUCED WITHOUT PRIOR CONSENT OF TIMCON DESIGN LTD.		