

Int

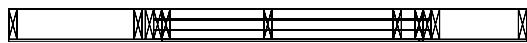

Ext

Timber Quantities								
Name	La.	Qt	W	H	LongL	CN	CP	ShortL
Bottom Plate	A	1	38	140	2397	0.00>0.00	0.00>0.00	2397
Top Plate	B	1	38	140	2397	0.00>0.00	0.00>0.00	2397
Beam	C	3	44	147	1286	0.00>0.00	0.00>0.00	1286
Cripples	D	2	38	140	2177	0.00>0.00	0.00>0.00	2177
Frame Rail	F	1	38	140	1210	0.00>0.00	0.00>0.00	1210
Window Rail	H	1	38	140	1210	0.00>0.00	0.00>0.00	1210
Jacks Over Ope	G	4	38	140	110	0.00>0.00	0.00>0.00	110
Jacks Under Ope	J	4	38	140	736	0.00>0.00	0.00>0.00	736
Stud	E	5	38	140	2324	0.00>0.00	0.00>0.00	2324

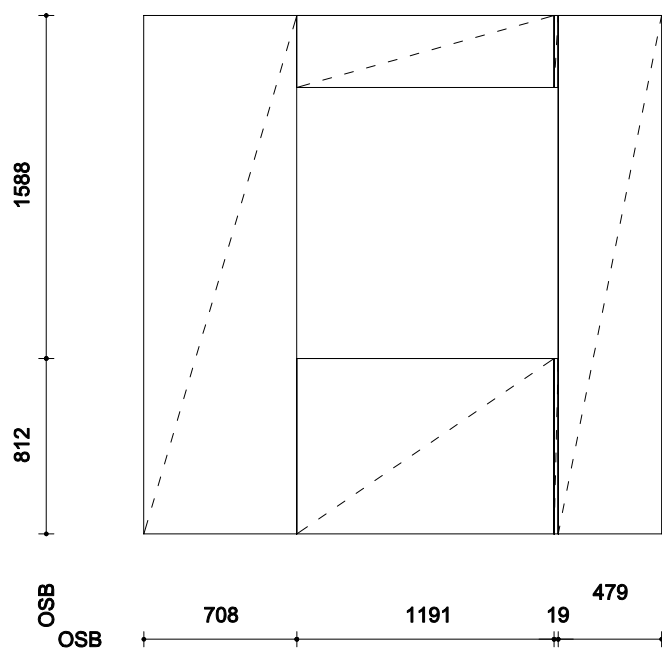
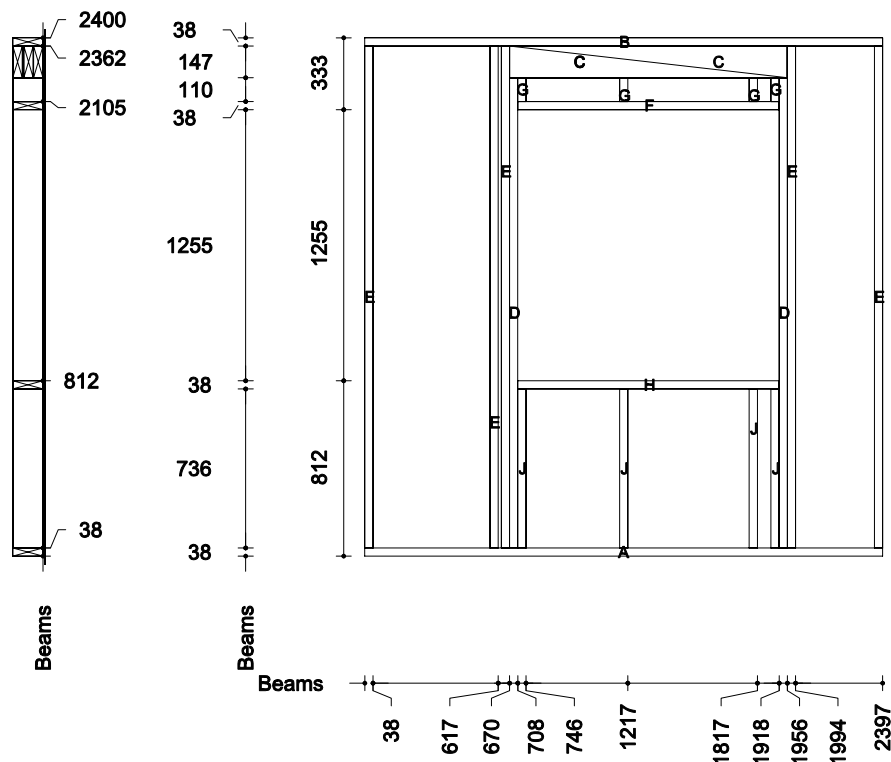

9mm OSB3 Quantities (Ext Face)			
Material	Qty	Width	Height
OSB	1	708	2400
OSB	1	1191	812
OSB	1	1191	333
OSB	1	19	812
OSB	1	19	333
OSB	1	479	2400

PLY NAILING 150/300

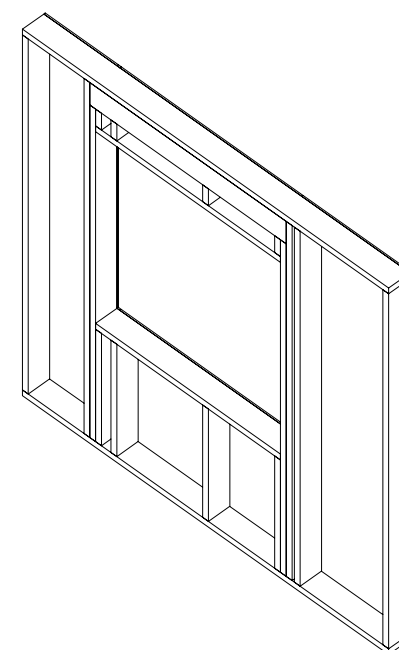

3D Isometric View

TimCon Design Ltd Independent Timber Frame Design Consultants	Site:	Example	PANEL WEIGHT	90KG	GF-EX03 <small>THIS DRAWING IS COPYRIGHT ©</small>
	Job No:	***	PANEL TIMBER BY VOLUME	26.8539%	
	Comment:	Plot 1 - GF	PANEL TIMBER BY AREA	27.0981%	
	Drawn By:	MC	AREA OF INSULATION REQUIRED	3.28957M2	
	Date:	April 24, 2007	Breather paper area:	5.94 m2	